

# DETAILED MEASUREMENTS

ALUMINIUM RAILING EXTERIOR MOUNTED - STANDARD HEIGHT POST

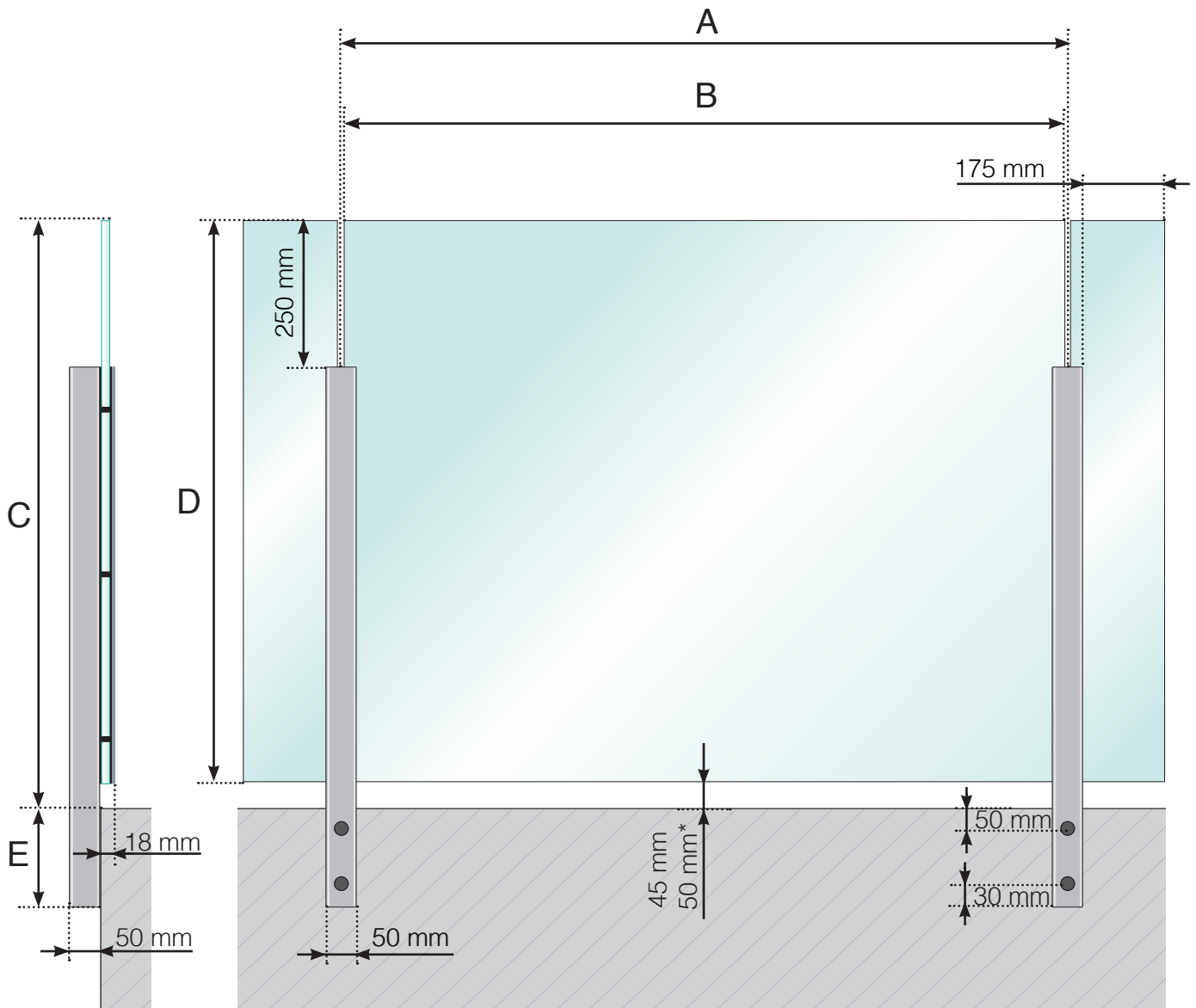

A - The c/c dimensions of the posts depend on the length of the sides and number of sections

B - The width of the glass depends on the length of the sides and the number of sections

C - Total height of the railing

D - Glass height

E - 145, 195, 250 or 350 mm

\* - Only when  $A \geq 1300$  mm.

Please note that the drawings are not to scale

© Räckesbutiken Sweden AB - [www.balustradestore.eu](http://www.balustradestore.eu)

2018-11-01 v.1.0



BALUSTRADESTORE.EU



# DETAILED MEASUREMENTS

## ALUMINIUM RAILING EXTERIOR - HIGH POST

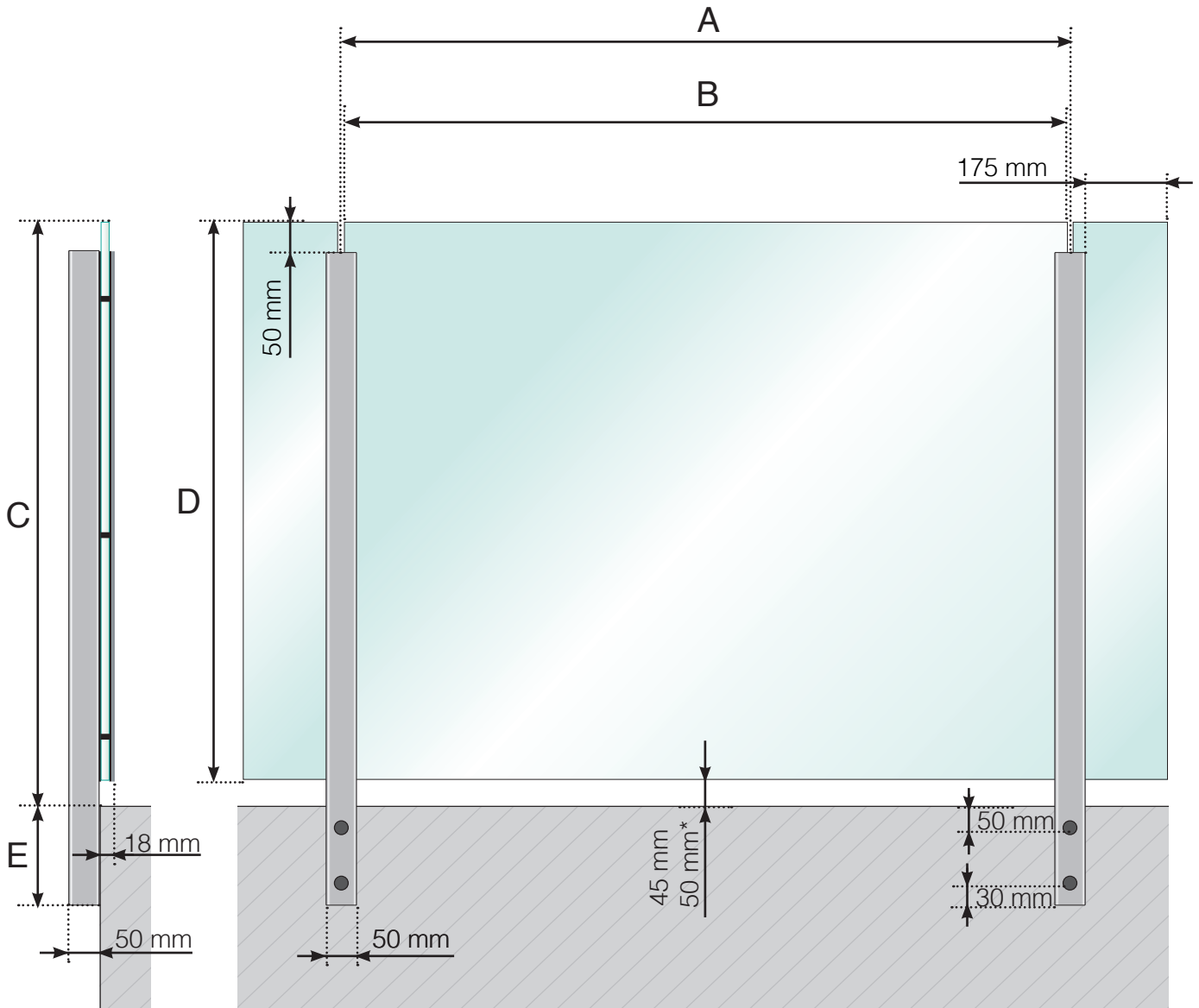

- A - The c/c dimensions of the posts depend on the length of the sides and number of sections
- B - The width of the glass depends on the length of the sides and the number of sections
- C - The height of the railing from the floor surface
- D - Glass height
- E - 145, 195, 250 or 350 mm

\* - Only when  $A \geq 1300$  mm.

Please note that the drawings are not to scale

© Räckesbutiken Sweden AB - [www.balustradestore.eu](http://www.balustradestore.eu)

2022-10-10 v.1.0



BALUSTRADESTORE.EU

# DETAILED MEASUREMENTS

## ALUMINIUM RAILING EXTERIOR - HIGH POST ALUMINUM GLASS STRIP

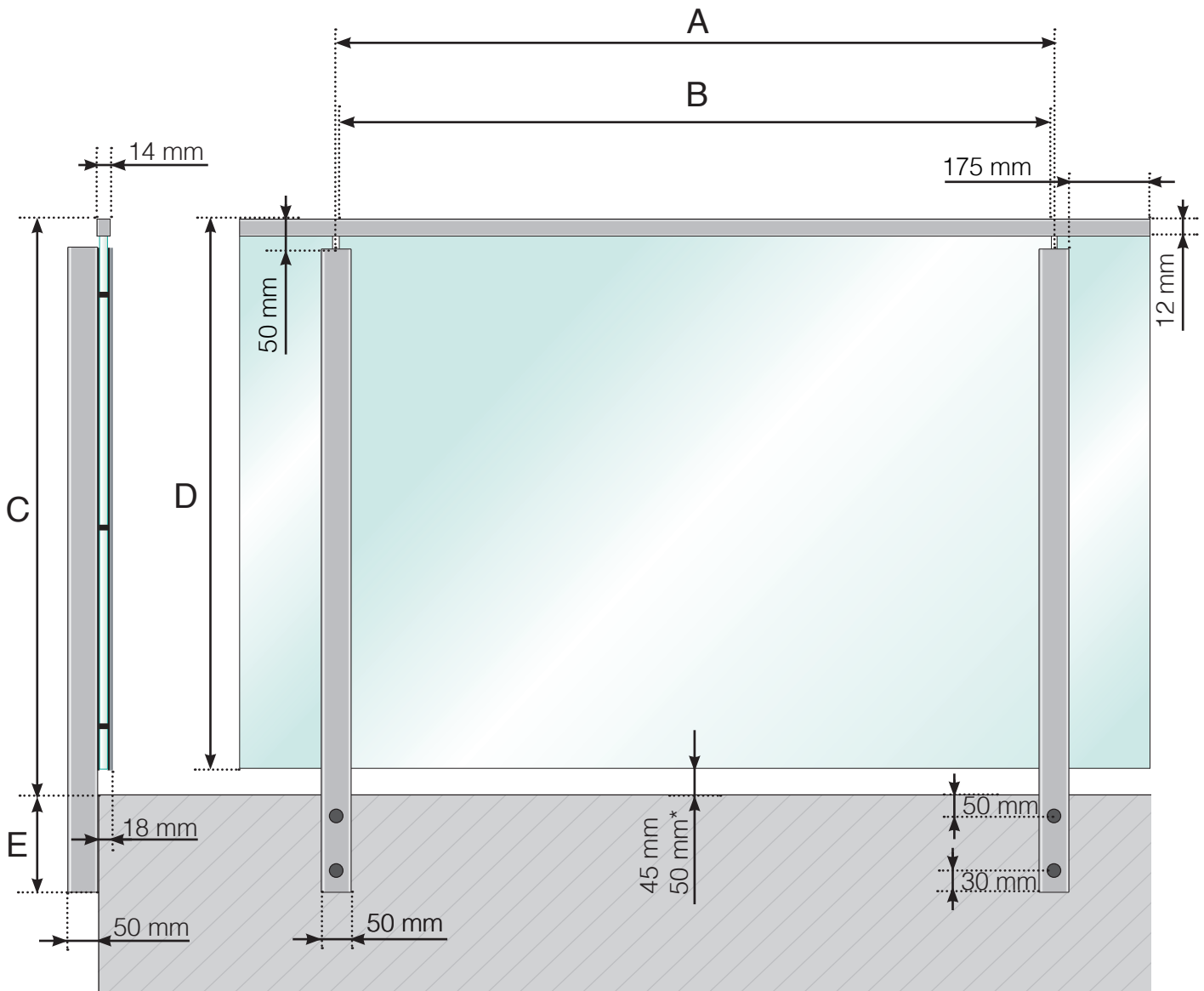

A - The c/c dimensions of the posts depend on the length of the sides and number of sections

B - The width of the glass depends on the length of the sides and the number of sections

C - The height of the railing from the floor surface

D - Glass height

E - 145, 195, 250 or 350 mm

\* - Only when  $A \geq 1300$  mm.

Please note that the drawings are not to scale

© Räckesbutiken Sweden AB - [www.balustradestore.eu](http://www.balustradestore.eu)

2022-10-10 v.1.0



BALUSTRADESTORE.EU